

# ROYAL<sup>®</sup>

APPLIANCE MFG. CO.

**OWNER'S MANUAL**  
Operating and Servicing  
Instructions

## COMMERCIAL BACK PACK CLEANING SYSTEM

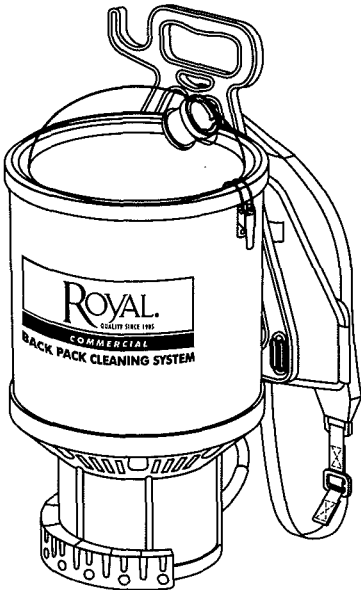

- Please read these instructions carefully before using your Royal Back Pack Cleaning System.
- Let us help you put your cleaner together or answer any questions.

**Call:**

**1-800-321-1134**

(USA & Canada)

**Website:**

**[www.royalvacuums.com](http://www.royalvacuums.com)**

### **WARNING**

**Cleaner assembly may include smaller parts. Small parts can present a choking hazard.**

For quick reference, please record your vacuum unit's information below:

Model#: .....

Mfg. code: .....

(Mfg. code located on the lower backside of cleaner)

## CONSUMER INFORMATION

# IMPORTANT SAFETY INSTRUCTIONS

When you use an appliance, basic precautions should always be followed, including the following:

- READ ALL INSTRUCTIONS BEFORE USING THIS APPLIANCE
- ALWAYS FOLLOW THESE SAFETY INSTRUCTIONS
- DO NOT LEAVE CLEANER UNATTENDED
- WARNING - FULLY ASSEMBLE CLEANER BEFORE OPERATING
- WARNING: THE CORDS, WIRES AND/OR CABLES SUPPLIED WITH THIS PRODUCT CONTAINS CHEMICALS, INCLUDING LEAD OR LEAD COMPOUNDS, KNOWN TO THE STATE OF CALIFORNIA TO CAUSE CANCER AND BIRTH DEFECTS OR OTHER REPRODUCTIVE HARM. WASH HANDS AFTER USING.

## **WARNING: TO REDUCE THE RISK OF FIRE, ELECTRIC SHOCK OR INJURY:**

- Do not leave appliance when plugged in. Unplug from outlet when not in use and before servicing.
- Do not use outdoors or on wet surfaces.
- Do not allow to be used as a toy. Close attention is necessary when used by or near children.
- Use only as described in this manual. Use only manufacturer's recommended attachments.
- Do not use with damaged cord or plug. If appliance is not working as it should, has been dropped, damaged, left outdoors, or dropped into water, return it to a service center for inspection. Call 1-800-321-1134 for the nearest service center.
- Do not pull or carry by cord, use cord as a handle, close a door on cord, or pull cord around sharp edges or corners. Do not run appliance over cord. Keep cord away from heated surfaces.
- Do not unplug by pulling on cord. To unplug, grasp the plug, not the cord.
- Do not handle plug or appliance with wet hands.
- Do not put any object into openings. Do not use with any opening blocked; keep free of dust, lint, hair and anything that may reduce air flow.
- Keep hair, loose clothing, fingers, and all parts of body away from openings and moving parts.
- Turn off all controls before unplugging.
- Use extra care when cleaning on stairs.

- Do not use to pick up flammable or combustible liquids, such as gasoline, or use in areas where they may be present.
- Look on your vacuum cleaner and follow all label and marking instructions.
- Do not use an extension cord with this cleaner.
- Keep end of hose, wands and other openings away from your face and body. Keep your hands, feet, hair and clothing away from moving parts.
- Do not use the vacuum cleaner without dust bag and/or filters in place.
- Store the vacuum cleaner indoors. Put the vacuum cleaner away after use to prevent tripping accidents.
- Do not pick up anything that is burning or smoking, such as cigarettes, matches, or hot ashes.
- Connect to a properly grounded outlet only. See grounding instructions below.
- Please note, on the power switch, 'I' indicates power "on" and 'O' indicates power "off".

Approved by the Vacuum Cleaner Manufacturer's Association  
Executive Committee, April 29, 1987.

## SAVE THESE INSTRUCTIONS

Your cleaner contains a Thermal Protector which will automatically shut off the motor at abnormally high motor temperatures. If the Thermal Protector is activated - turn main switch off and unplug the cleaner. Inspect the exhaust, inlet, hose, dirt container and secondary filter for any blockage. After approximately 30 minutes the motor will have cooled and the vacuum will be ready to use. NOTE: The cleaner must remain unplugged during the 30 minute cooling period.

## GROUNDING INSTRUCTIONS

This appliance must be grounded. If it should malfunction or breakdown, grounding provides a path of least resistance for electric current to reduce the risk of electric shock. This appliance is equipped with a cord having an equipment-grounding conductor and grounding plug. The plug must be inserted into an appropriate outlet that is properly installed and grounded in accordance with all local codes and ordinances.

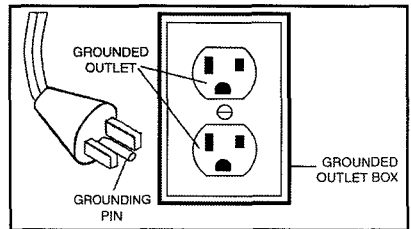

## WARNING

Improper connection of the equipment-grounding conductor can result in a risk of electric shock. Check with a qualified electrician or service person if you are in doubt as to whether the outlet is properly grounded. DO NOT modify the plug provided with the appliance - if it will not fit the outlet, have a proper outlet installed by a qualified electrician.

This appliance is for use on a nominal 120-volt circuit and has a grounding attachment plug that looks like the plug in the sketch.

Make sure that the appliance is connected to an outlet having the same configuration as the plug.

**No adapter should be used with this appliance.**

## CONGRATULATIONS

You are now the proud owner of the Royal Commercial Back Pack Cleaning System. We trust your new purchase will bring you many years of satisfaction.

We are very proud of our products and hope that you are equally satisfied with their quality and performance.

From today, you can look forward to productivity rates over 7000 square feet per hour\* from a commercial quality back pack specifically designed to maximize operator comfort and perform quieter, longer, day-in, day-out.

Our unique system is:

- Light and easy to use.
- Has less likelihood of disconnections.
- Quieter operation ...and most importantly, the W.O.W. Productivity System™.

W. = 'Wear right!'

O. = 'Operate right!!'

W. = 'Work right!!!'

Its simple, if you are wearing a correctly and comfortably adjusted machine, using the right working posture and working to a methodical plan of both 'detail' and 'spot' cleaning, you'll finish your work less tired, without sore shoulders and an aching back ...and that means increased productivity.

Thank you for your support of Royal® products.

Please visit our website at [www.royalvacuums.com](http://www.royalvacuums.com)

\* Source: ISSA 'Cleaning Times'. August 2001

# TABLE OF CONTENTS

Safety Instructions .....	Page 2 - 3
‘Congratulations’ .....	Page 4
Table of Contents .....	Page 5
Feature Description / Back Pack Vacuum .....	Page 6
Feature Description / Accessories .....	Page 7
Safety & Maintenance Checks.....	Page 8
WOW Productivity System™.....	Page 9
‘Wear right!’ .....	Page 10
‘Operate right!’ .....	Page 11
‘Work right!’ .....	Page 12
Troubleshooting Guide .....	Page 13
Any other Servicing.....	Page 14
Warranty .....	Page 15

# FEATURES

## RY4000 - HYPERCONE™ AIRFLOW SYSTEM

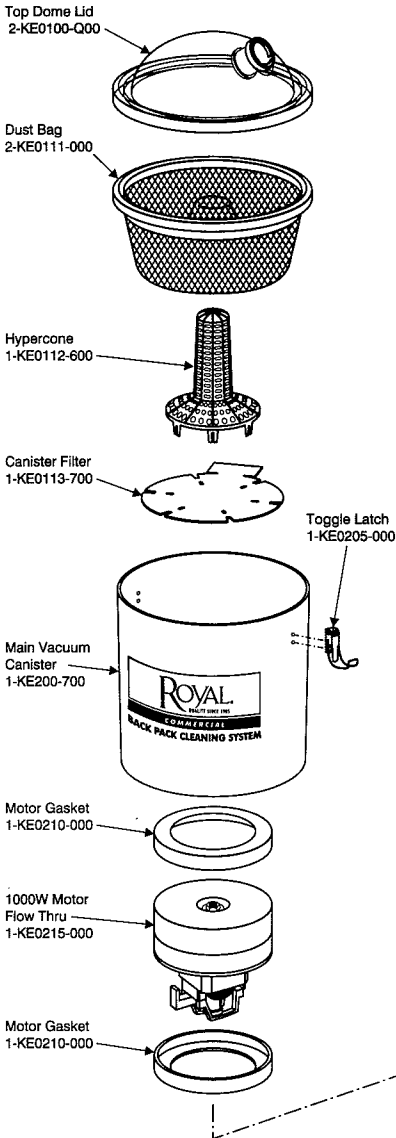

Quote these part numbers  
when ordering spare parts

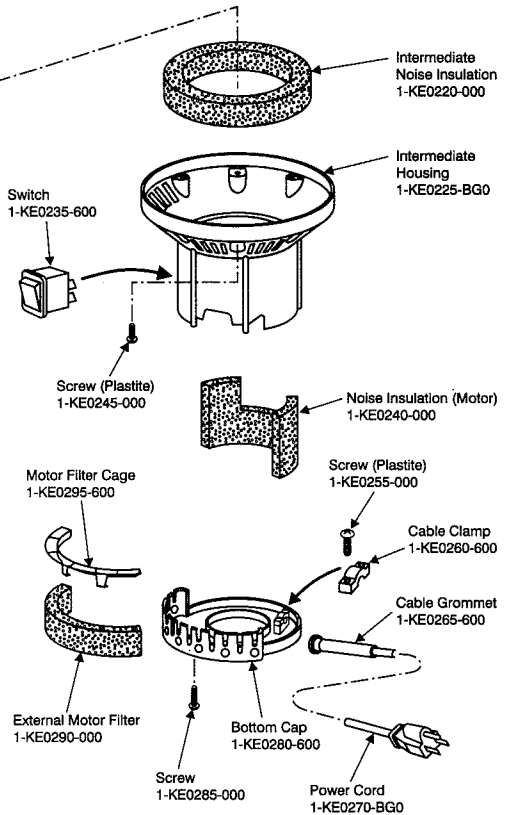

# FEATURES

## HARNES & ACCESSORIES

### HARNES ASSEMBLY

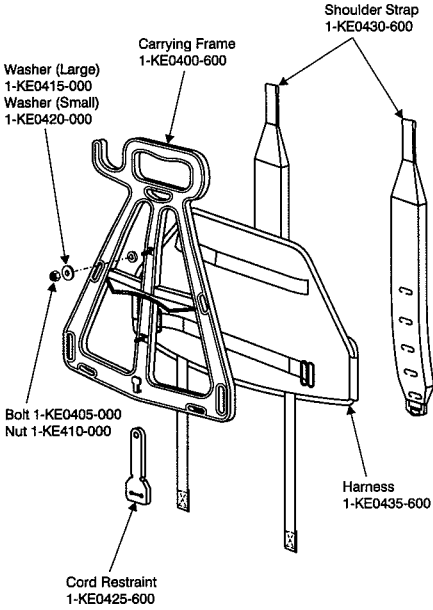

### ACCESSORIES

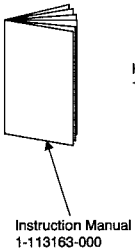
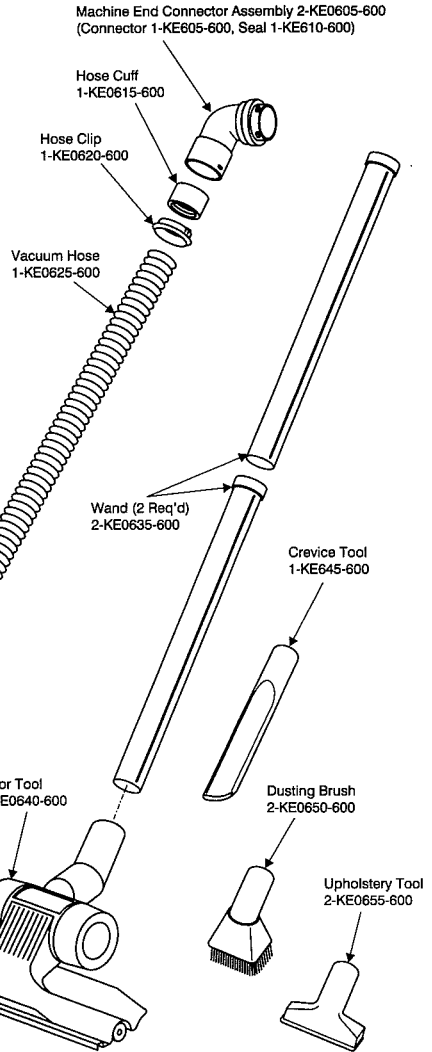

# SAFETY & MAINTENANCE CHECKS

**1.**

**DAILY:**

Remove and empty dust bag.

**WEEKLY:**

Remove and clean external motor filter.

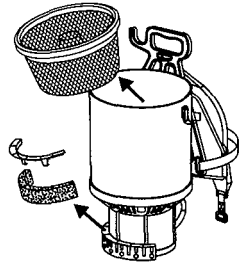

**2.**

**EVERY THREE MONTHS:**

Remove and replace the active filter for the machine to operate at peak performance.

**Note:**

Remove Hypercone to release active filter.

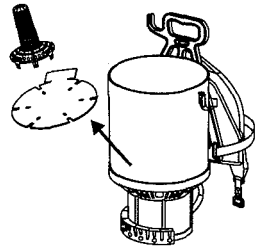

**3.**

**DAILY:**

Inspect all electrical cords.

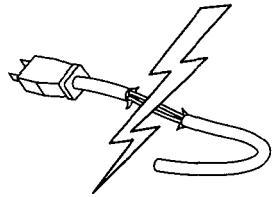

**4.**

Regularly check for any obstructions.

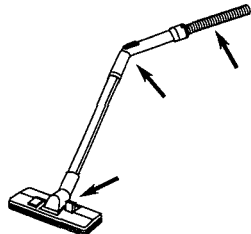

# WOW PRODUCTIVITY SYSTEM™



The WOW Productivity System™ was developed following extensive and on-going consultation with operators, purchasers, trainers and operations managers worldwide.

No matter what the market or the degree of exposure to back pack technology, the most common request was for ways to make back pack vacs easier and more comfortable to use so that productivity could be increased ...without additional strain and stress on operators.

What was missing was the fact that no-one had really explored the potential of well-trained operators who knew precisely how to correctly and comfortably use the machine ...and to maximize the unique flexibility of the back pack design in specific cleaning situations.

So, the 'W.O.W!' Productivity System™ was born!

'WOW!' - it couldn't be easier.

'Wear right!'

'Operate right!!'

'Work right!!!'

Say goodbye to a sore back and shoulders at the end of each shift.

Get through your work easier and faster.

Vacuum hard and carpeted floors effortlessly.

Get a cleaner floor, from the first square foot to the last.

Maintain upright pile for a better looking carpet.

WOW! - what could be better?

# WOW PRODUCTIVITY SYSTEM™

## 'WEAR RIGHT!'

1. Ensure hose is connected to clear dome lid, with the outlet on the same side as your 'vacuuming arm'.
2. Loosen shoulder straps until only about 4 - 5 inches remain.
3. Lift machine with one hand, while sliding the other arm through one of the straps. Then put the other arm through the remaining strap. (Diagram 1.)
4. Let the machine settle into the 'small' of your back, right at your waist line. (Diagram 2.)
5. Tighten waist band until secure and comfortable. (Diagram 3.)
6. Pull down on both remaining ends of the shoulder straps until you can feel that almost all of the weight of the machine (95%) is being carried by the waist band. (Diagram 4.)
7. Further adjust the shoulder straps for comfort. (You should be able to easily insert your finger between each strap and shoulder.)
8. Tighten waist band if necessary.

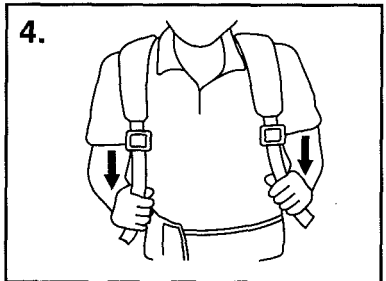
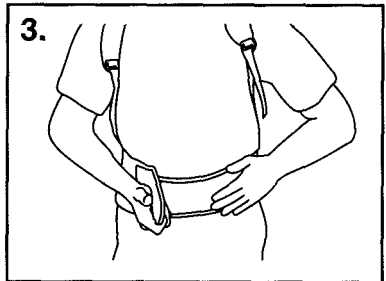
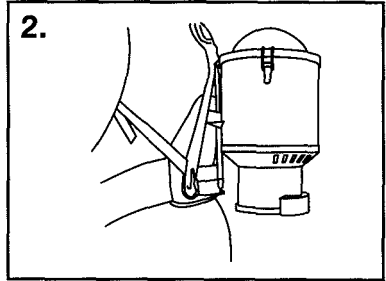
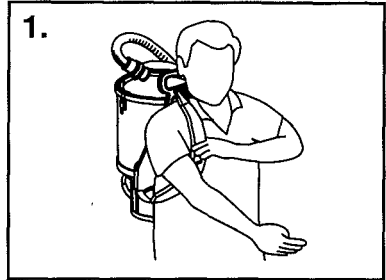

# WOW PRODUCTIVITY SYSTEM™

'OPERATE RIGHT!'

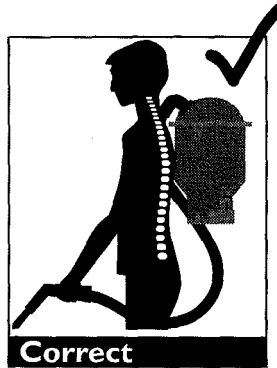

## How to vacuum easier, faster with less back strain:

1. Stand upright, with the handle grip section of the wand parallel to the floor. It should be at a comfortable arm's length. One hand only on wand.
2. Move forward and away from the power source.
3. Use easy underarm swinging motions when detail cleaning and short 'dabs' when spot cleaning ...always standing upright.
4. Once the end of the power cord has been reached and work completed, return to power source.
5. Disconnect cord from power outlet:
  - a. If work not finished, unplug cord from outlet, then wind from back pack towards the end of the cord (reduces likelihood of cord twists, fractures and knots).
  - b. If work completed, remove back pack by sliding left strap off shoulder while raising right arm / shoulder to hold strap in place. Slowly lower right shoulder and lower unit to floor (DO NOT DROP!)
6. Move to next power outlet or cleaning area and repeat.

# WOW PRODUCTIVITY SYSTEM™

## 'WORK RIGHT!'

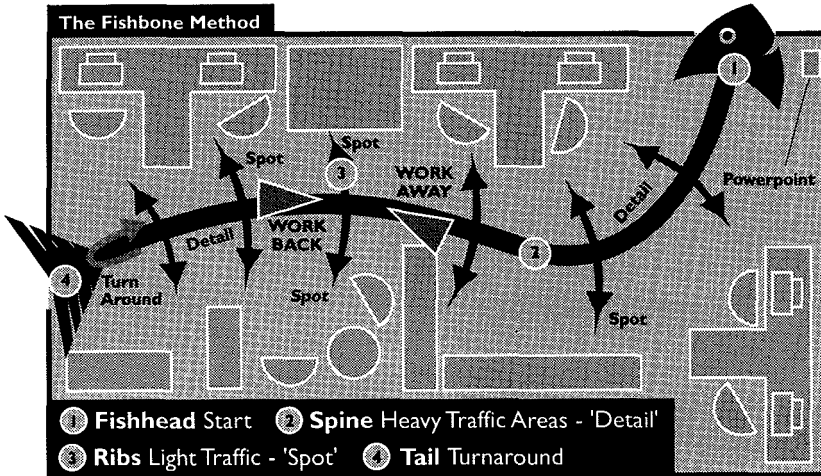

## LOOK FOR LAYOUT

1. Find the most easily accessible outlet. This is your starting location...at the fish's 'head'. Your turnaround is the 'tail'.
2. Check and remember the hard floor and carpeted areas and where they are on the fishbone.
3. Check the room layout - position of desks, tables and chairs.
4. Check the condition of the floor - how dirty it is on a scale of 10.

## PLAN THE PROCESS

1. Work away from the power outlet.
2. Work one side of the fishbone towards the tail. Then back the other side toward head. Work to the plan - long strokes for the detail cleaning and short 'stabs' for spot cleaning areas.

## GO FOR IT

1. See in your mind the fishbone (or fishbones) over the entire area or room to be cleaned.
2. Decide which areas are to be 'detail cleaned' (the backbone) or 'spot cleaned' (the ribs).

# TROUBLESHOOTING GUIDE

**WARNING: TO REDUCE RISK OF PERSONAL INJURY, UNPLUG CLEANER BEFORE SERVICING**

<b>Problem:</b>	<b>Possible reasons</b>	<b>Possible solutions</b>
Cleaner won't run	1. Power cord not firmly plugged into outlet	1. Plug cord in firmly
	2. Blown fuse or tripped breaker	2. Check fuse or breaker. Replace fuse / reset breaker
	3. Needs service	3. Take to service center OR call 1- 800- 321-1134
	4. Thermal protector shuts cleaner off due to high motor temperatures	4. Review Safety Instructions on page 3 OR call 1- 800- 321-1134
Cleaner won't pick-up or low suction	1. Dust bag not installed correctly	1. Empty and replace dust bag
	2. Dust bag full	2. Remove and replace dust bag
Dust escaping from cleaner	1. Dust bag full	1. Empty and replace dust bag
	2. Dust bag not installed correctly	2. Remove and replace dust bag
	3. Hose not installed correctly	3. Reconnect hose
Cleaner tools won't pick up	1. Hose clogged	1. Remove hose and tools; remove obstruction
	2. Hose inlet clogged	2. Remove hose and clean inlet
	3. Dust bag full	3. Remove and replace dust bag
	4. Filter clogged	4. Clean filter

**FOR ANY OTHER SERVICING, SEE DETAILS ON PAGE 14**

## **ANY OTHER SERVICING**

**THIS SHOULD ONLY BE DONE BY AN  
AUTHORIZED SERVICE REPRESENTATIVE**

**TO LOCATE A DEALER NEAR YOU, VISIT OUR WEBSITE**

**[www.royalvacuums.com](http://www.royalvacuums.com)**

**OR CALL CUSTOMER SERVICE AT**

**1-800-321-1134**

In the event that any further servicing is required, see your Yellow Pages for an authorized Royal Dealer. Costs of any transportation to and from any place of repair are to be paid by the owner. The service parts used in this unit are easily replaced and readily available from an authorized Royal Dealer or retailer. Always identify your cleaner by the model number and manufacturing code when requesting information or ordering replacement parts. (The model number appears on the bottom of the cleaner).

## LIMITED WARRANTY

To the consumer, Royal Appliance Mfg.Co warrants this vacuum cleaner to be free of defects in materials or workmanship for 2 years from the date of original purchase.

Save your original sales receipt to validate start of your warranty period.

If the vacuum cleaner should become defective within the warranty period, we will repair or replace any defective parts free of charge. The complete machine must be delivered prepaid to any Royal Authorized Sales and Warranty Service Station. Please include complete description of the problem, day of purchase, copy of your original sales receipt and your name, address and telephone number. If you are not near a warranty station, call the factory for assistance at USA or Canada 1-800-321-1134.

Use only genuine Royal® Replacement Parts.

The Warranty does not include unusual wear and tear, damage resulting from accidental or unreasonable use of the vacuum cleaner. The Warranty does not cover brushes, flat belts, filters, bulbs. This Warranty does not cover unauthorized repairs. This Warranty gives you specific legal rights and you may also have other rights. (Other rights may vary from State to State in the USA)

# ROYAL<sup>®</sup>

APPLIANCE MFG. CO.



**WOW** ✓

**WEAR RIGHT! OPERATE RIGHT!! WORK RIGHT!!!**